

Conectar-se

na rede EDUROAM

UNIVERSIDADE



LUSÓFONA
DO PORTO

em 4 passos:

Windows 10

1

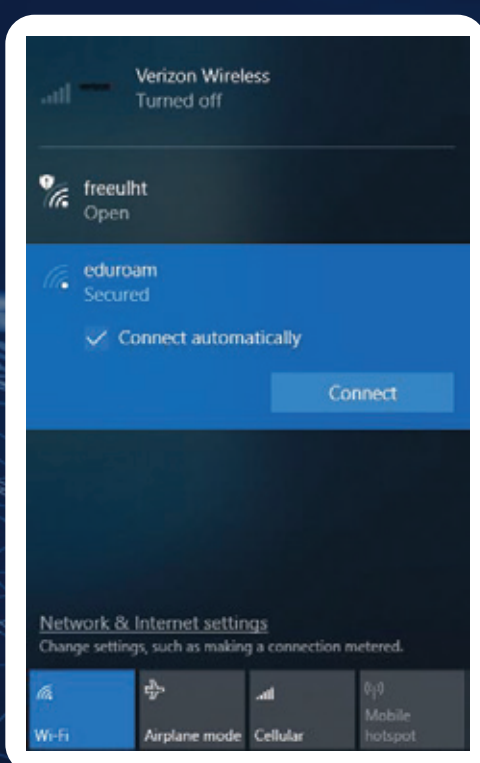

Selecionar a rede desejada (Eduroam)

2

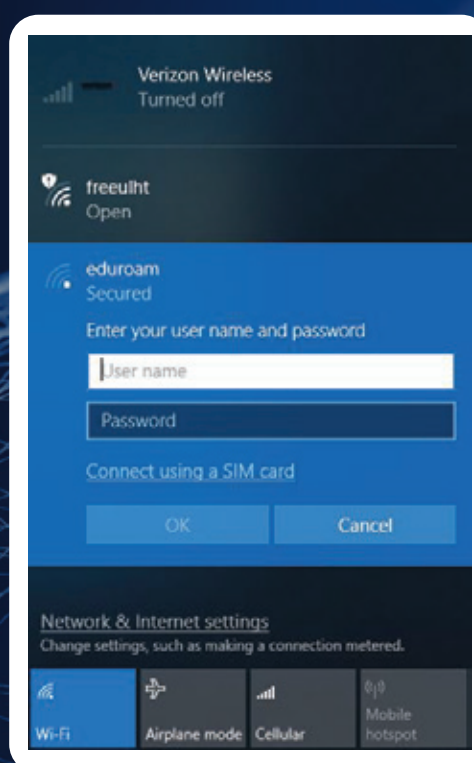

Introduzir as suas credenciais (email e password)

3

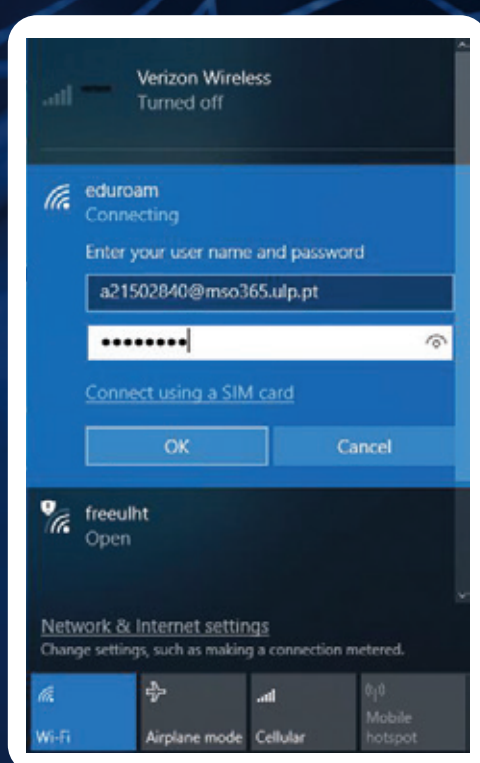

Verifique que utilizador introduzido condiz com o seu email institucional

4

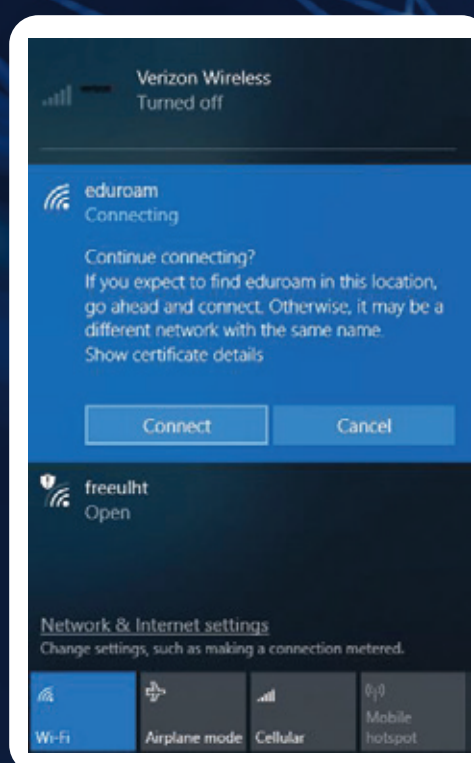

No primeiro acesso à rede Wi-Fi, deverá seleccionar "Connect"

email institucional:

Aluno
axxxx@mso365.ulp.pt

Docente
pxxxx@mso365.ulp.pt ou pxxxx@ulp.pt